

SENSORY MAP

For Seniors, Persons with Physical Disabilities
and/ or Dementia

This map of the Singapore History Gallery indicates areas where there may be excessive light or sound, or sudden changes. It also shows areas within the gallery that are relatively quiet. We recognise that not all sensitivities are accounted for in this map. Please speak with any Visitor Services staff if you or a loved one needs additional assistance.

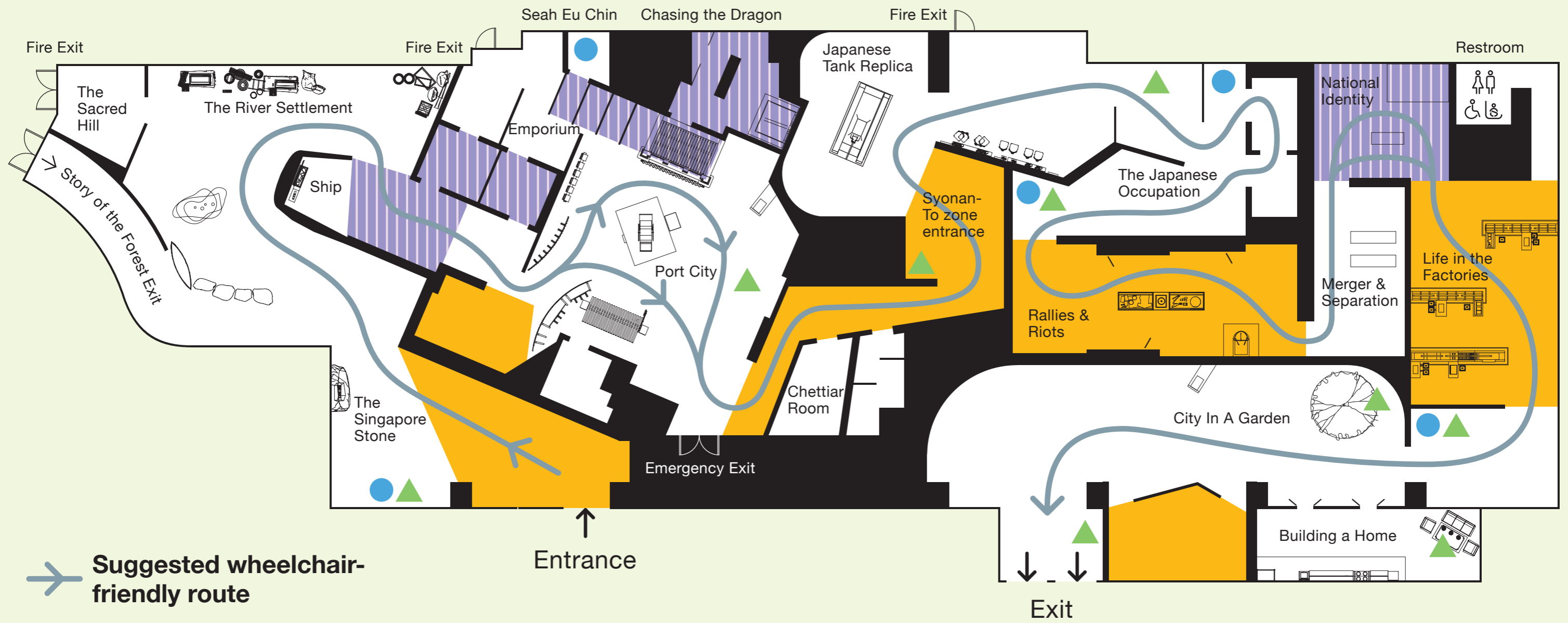

→ Suggested wheelchair-friendly route

● Quiet Corners
Calming areas that may be suitable for persons with special needs

▲ Seating Areas
Areas that may be shared by persons with special needs and other users who need a resting place

⬠ Surprise Areas
Areas with changes in light and/ or sound

▨ Dim Areas